

External

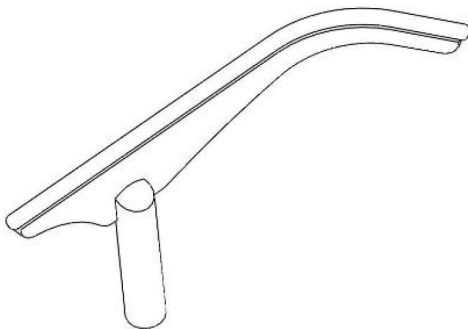

All dimension are +/- 1/8"

Original Comfort Rest With Hardened Rod

Available in 4, 6, 9, 12 & 15" Lengths

Cross Bar is 2 1/4" High

Post is 1" Diameter - other post sizes available special order

	Post Height	Overall Height
Long Post	5 1/4"	7 3/8"
Standard Post	3 3/4"	5 7/8"

Low Profile Rest With Hardened Rod

Available in 4, 6, 9 & 12" Lengths

Cross Bar is 1 1/4" High

Post is 1" Diameter - other post sizes available special order

	Post Height	Overall Height
Long Post	5 1/4"	6 1/2"
Standard Post	3 3/4"	5"
Short Post	2 3/4"	4"

Mini Rest With Hardened Rod

Available in 4, 6, 9 & 12" Lengths

Cross Bar is 1 1/4" High

Post is 5/8" Diameter - other post sizes available special order

	Post Height	Overall Height
Standard Post	2 3/4"	4"

Curved Tool Rests

Length of curve is 12"

Radius is apr. 8"

Interior Rest cross bar is 2 3/4" high, Exterior cross bar is 2 3/8" high

Post is 1" Diameter - other post sizes available special order

	Post Height	Overall Height
Long Post	5 1/4"	7 3/8"
Standard Post	3 3/4"	5 7/8"

14" J-Rests

Length of hardened Rod is 12"

Radius at end is apr. 3"

Cross bar is 2 1/4" high where it enters the banjo (tool holder)

Post is 1" Diameter - other post sizes available special order

	Post Height	Overall Height
Long Post	5"	7 1/4"
Standard Post	3 1/2"	5 3/4"

9" J-Rests

Length of hardened Rod is 9"

Radius at end is apr. 2"

Cross bar is 1 3/8" high where it enters the banjo (tool holder)

Post is 1" Diameter - other post sizes available special order

	Post Height	Overall Height
Long Post	5 1/8"	6 1/2"
Standard Post	3 5/8"	5 "
Short Post	2 3/4"	4 1/8"
Mini (5/8" diameter post)	2 5/8"	4"