

# INSTRUCTIONS FOR INSERTING BFE95 MATERIAL INTO YOUR MASK

Inserting the BFE95 material into your mask can be challenging because the material is thin and delicate. These instructions, together with the filter insertion card included in your kit, will greatly simplify inserting the filter into your mask.

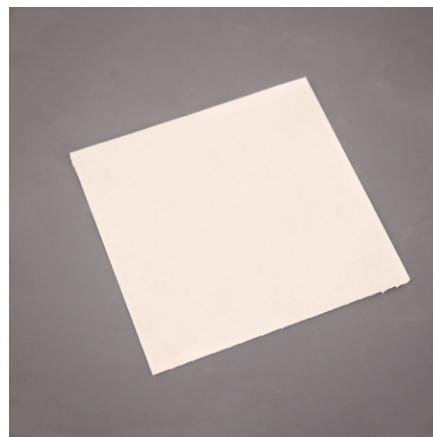

In your order, you received a mask and a length of BFE95 material which is about 5 1/2" wide and 40" long. Cut the BFE95 material into sections, which are 5 1/2" long. You can cut them into shorter sections if you want to save material and only need a smaller area of your face covered.

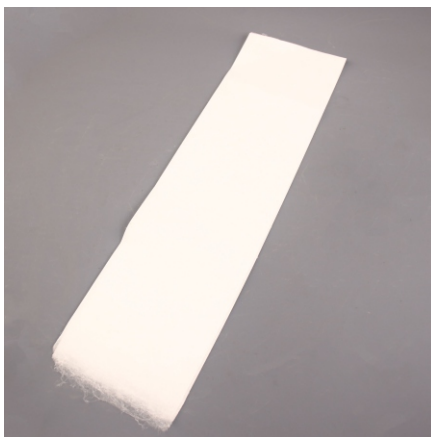
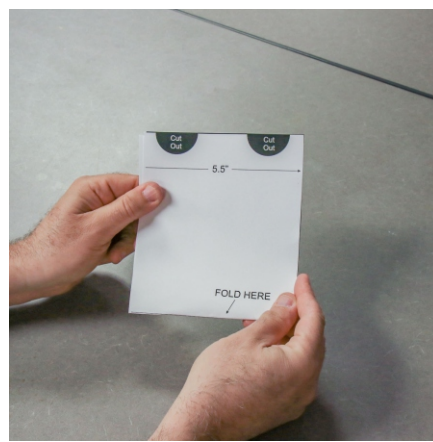
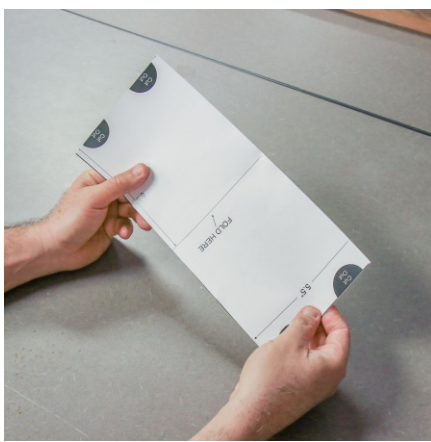
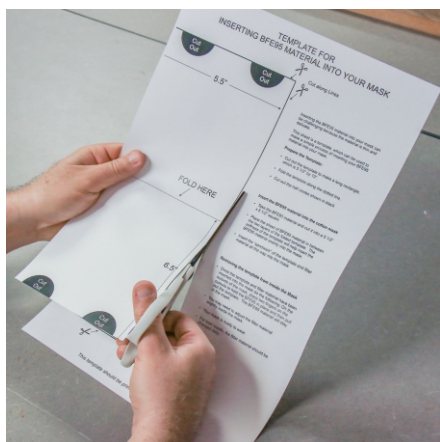

Cut out the template and fold it at the dotted line.

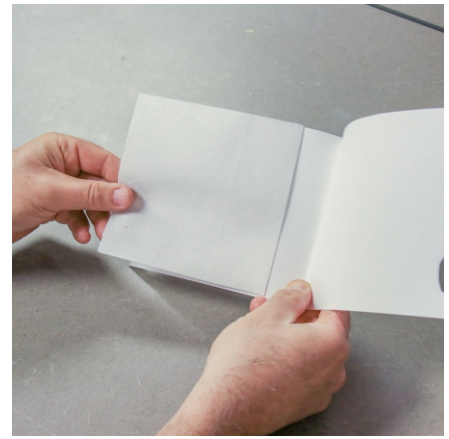

It is important that you cut out the two black semicircles so that you have notches in your paper. Open the folded paper and insert the filter material so it is at the far edge of the filter holder.

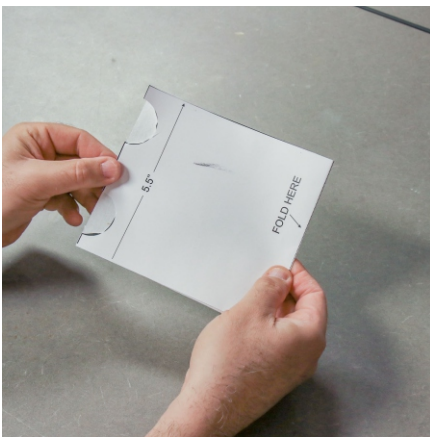

Fold the filter holder over so that the filter material inside and the filter is showing through the two notches. Carefully squeeze the filter holder and insert it into you mask. Push it in as far as it will go so that it is up against the opposite end of the mask. Take your time and adjust it as necessary.

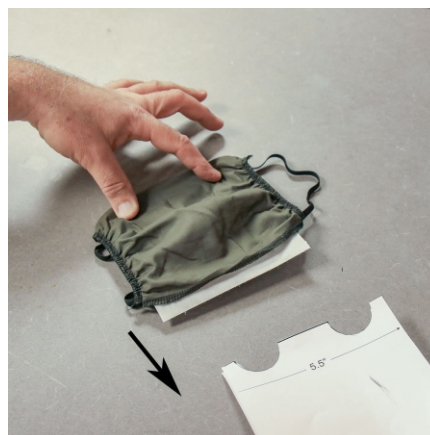
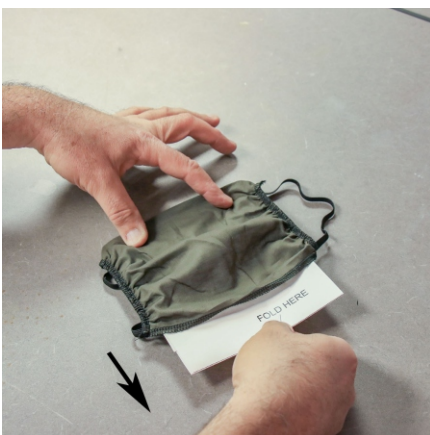

Now, you must remove the paper filter holder, while leaving the filter inside the mask ( that is what the notches were for! )

Using two fingers, feel for the notches and press down on the filter material in the notch cutout. Using your other hand, slide the paper holder out of the mask. The filter will stay inside. Adjust the filter so you have full coverage inside the mask. Your mask should be comfortable and easy to breathe through.